

B32

轻触式开关用开关头

B3F、B3FS、B3W的凸型 柱塞类型专用键顶

●有各种大小、形状、颜色等丰富的产品系列。

符合RoHS

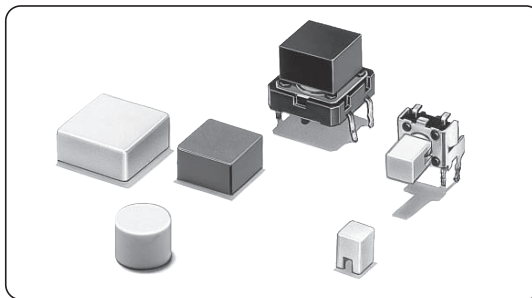

B
3
2

■种类

●B3F、B3FS、B3W专用

适用类型	6mm方形开关 B3F-1000、3000、6000系列 B3W-1000系列 B3FS系列			12mm方形开关 B3F-4000、5000系列、 B3W-4000系列			
键顶颜色	键顶大小	4×4mm	φ6mm圆型	D型	9×9mm	12×12mm	φ9.5mm
灰		B32-1000	B32-2000	B32-2100	B32-1200	B32-1300	B32-1600
黑		B32-1010	B32-2010	B32-2110	B32-1210	B32-1310	B32-1610
橙		B32-1020	—	—	B32-1220	B32-1320	B32-1620
黄		B32-1030	—	—	B32-1230	B32-1330	B32-1630
蓝		B32-1040	—	—	B32-1240	B32-1340	—
白		B32-1060	—	—	B32-1260	B32-1360	—
红		B32-1080	—	—	B32-1280	B32-1380	—

注：最小包装单位为1,000个/袋。订购数量必须为最小包装单位的整数倍。

■性能

使用环境温度	-25~+70°C 60%RH以下（无结冰、无凝露）
使用环境湿度	35~85%RH（+5~+35°C）

■外形尺寸（单位：mm）

B32-10□0

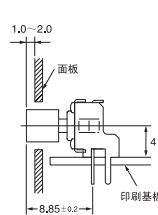
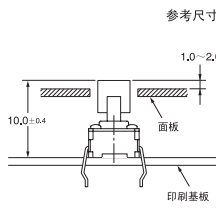
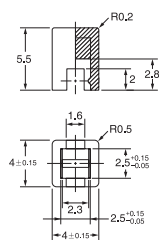

面板切割尺寸

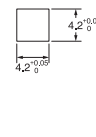

B32-2000 B32-2010

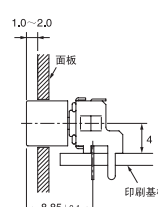
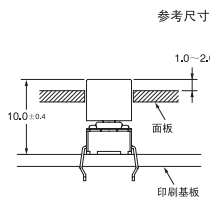
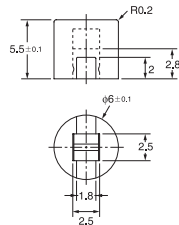

面板切割尺寸



A-214

OMRON

B32

轻触式开关用开关头

B32-2100
B32-2110

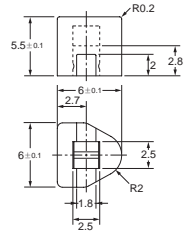

参考尺寸

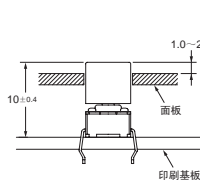

面板切割尺寸

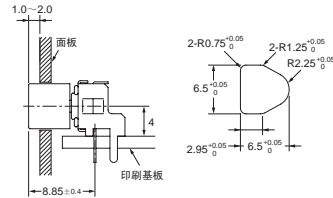

B32-12□0

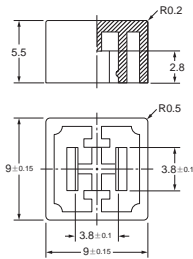

参考尺寸

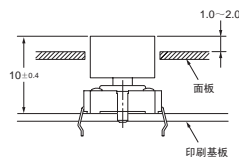

面板切割尺寸



B32-13□0

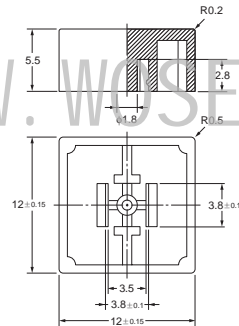

参考尺寸

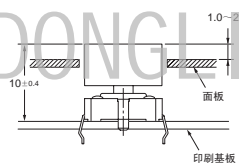

面板切割尺寸

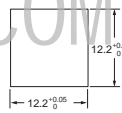

B32-16□0

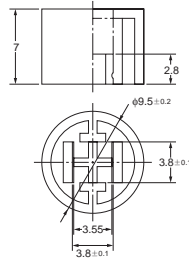

参考尺寸

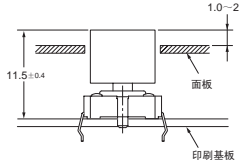

面板切割尺寸

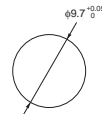

■请正确使用

注. 上述外形尺寸图中, 未注公差±0.4mm.

使用注意事项

- 关于焊接工序
因为不能承受焊接工序中的热量, 请务必在焊接工序后再安装到开关上。